

# Clarke®

## STRONG-ARM



**500KG MOTORCYCLE TABLE LIFT**

**MODEL NO: CML9**

PART NO: 7610203

## USER INSTRUCTIONS

UK  
CA | CE

ORIGINAL INSTRUCTIONS

GC 12/25

---

## **INTRODUCTION**

---

Thank you for purchasing this CLARKE Motorcycle Table Lift.

Before attempting to use this product, please read this manual thoroughly and follow the instructions carefully. In doing so you will ensure the safety of yourself and that of others around you, and you can look forward to your purchase giving you long and satisfactory service.

---

## **SPECIFICATION**

---

Max Rated Load	500 kg
Product weight	12.65 kg
Product dimensions	410 x 265 x 95 mm
Min height of table	95 mm
Max height of table	360 mm

---

## **GUARANTEE**

---

This product is guaranteed against faulty manufacture for a period of 12 months from the date of purchase. Please keep your receipt which will be required as proof of purchase.

This guarantee is invalid if the product is found to have been abused or tampered with in any way, or not used for the purpose for which it was intended.

Faulty goods should be returned to their place of purchase, no product can be returned to us without prior permission.

This guarantee does not effect your statutory rights.

---

## **SAFETY PRECAUTIONS**

---

1. Ensure that the lift is in good working order. Have any damaged parts repaired or replaced immediately. Use genuine CLARKE parts only. The use of unauthorised parts may be dangerous and will invalidate the warranty.
2. Only use the lift in a suitable, well lit work area.
3. Keep the work area clean and tidy and free from unrelated items.
4. Use the lift on level and solid ground, preferably concrete. Avoid soft/unmade ground as the lift may sink in.
5. Ensure the engine is switched off and the transmission is in 1st or reverse gear.
6. Ensure a minimum distance of 0.5 m between the motorcycle and static objects such as doors, walls, etc, to allow for the motorcycle tilting.
7. Check the lifting point is rigid and centred on the lift saddles.
8. Place chocks under the wheels of the motorcycle.
9. Keep all non-essential persons at a safe distance whilst the lift is in use.
10. Ensure there are no personnel or obstructions under the motorcycle before lowering.
11. Take care not to trap fingers in the moving parts of the lift.
12. **DO NOT** allow personnel to operate the lift unless they have read these safety precautions.
13. **DO NOT** exceed the rated capacity of the lift.
14. **DO NOT** lift a motorcycle if there is a risk of spillage of fuel, battery acid or other dangerous substances.
15. **NEVER** tamper with the product or modify it in any way, as this could prove to be dangerous and will invalidate the guarantee. Only use the product for the purpose for which it is intended.
16. When not in use, store the lift fully lowered, in a safe, dry, childproof area.
17. No responsibility can be accepted for incorrect use of the lift.

### **LIFTING OPERATIONS AND LIFTING EQUIPMENT REGULATIONS 1998**

This lift, depending on use, may fall within the scope of LOLER. It is the owner's responsibility to determine whether or not it does and, if so, to comply with any applicable requirements in LOLER, for having the lift thoroughly examined.

---

# OPERATING INSTRUCTIONS

---



**WARNING: BEFORE LIFTING, ENSURE THE SAFETY PRECAUTIONS ARE STRICTLY FOLLOWED.**

**WARNING: BEFORE USE, ENSURE THAT THE MOTORCYCLE HAS A SUITABLE STRUCTURE AND CENTRE OF GRAVITY TO ACCOMMODATE THE LIFT SUPPORTS WITHOUT DAMAGING THE MOTORCYCLE.**

---



**CAUTION: DO NOT USE THE LIFT IF IT WILL FOUL ON THE EXHAUST OR OTHER VULNERABLE PARTS. IF NECESSARY REMOVE ANY LOWER FAIRING AND ENSURE THAT THE MOTORCYCLE IS STABLE ON THE SUPPORTS BEFORE OPERATING.**

---

## POSITIONING THE LIFT

The lift is raised by turning the spindle with the 21mm box wrench provided. **DO NOT** attempt to use a power tool.

1. Position the motorcycle in a suitable area, checking that the surface on which the lift will be placed is solid and flat (preferably concrete).
2. Ensure there is good access and clearance beneath the motorcycle for the lift.
  - The lift can be also be used in conjunction with a motorcycle that is already raised on a motorcycle lift. Ensure that the lift is fully located on the lift platform.
3. Inspect the underside of the motorcycle for suitable support points, bearing in mind the centre of gravity of the motorcycle and which wheel is to be lifted from the ground.
4. Place the lift under the motorcycle in the approximate position required.

## LIFTING THE MOTORCYCLE

1. Use the box wrench to raise the platform until the platform reaches the intended points of contact on the underside of the motorcycle. Adjust the position of the lift as necessary and proceed to raise the motorcycle.
2. Turn the box wrench slowly and evenly to ensure no sudden movements of the motorcycle.
3. For additional security it is advisable to retain the motorcycle on the stand with suitable straps, especially if the motorcycle is already raised from the ground on a motorcycle lift.

## LOWERING THE MOTORCYCLE

1. When work is complete, check under the lift platform to ensure that there are no obstructions and that it is safe to lower the unit.
2. Slowly turn the box wrench anti-clockwise to lower the motorcycle.



**WARNING: ALWAYS LOWER IN A SLOW AND CONTROLLED MANNER AND ENSURE THERE ARE NO PERSONS OR OBSTACLES BENEATH THE MOTORCYCLE, OR IN THE PATH OF ITS DESCENT.**

---

3. When the lift is fully lowered, ensure that the motorcycle is standing on its wheels and is supported in the upright position.

---

## CARE AND MAINTENANCE

---

1. Keep the lift clean and lubricate moving parts with grease if required.
2. Before each use check for broken, cracked, bent, or loose parts, or any visible damage to welds and all parts including pins and other fasteners. If any suspect item is found remove from service and take necessary action to remedy the problem.
3. **DO NOT** use the lift if believed to have been subjected to abnormal load or shock. Inspect and take appropriate action.
4. Store the lift in its lowest position in a dry location.

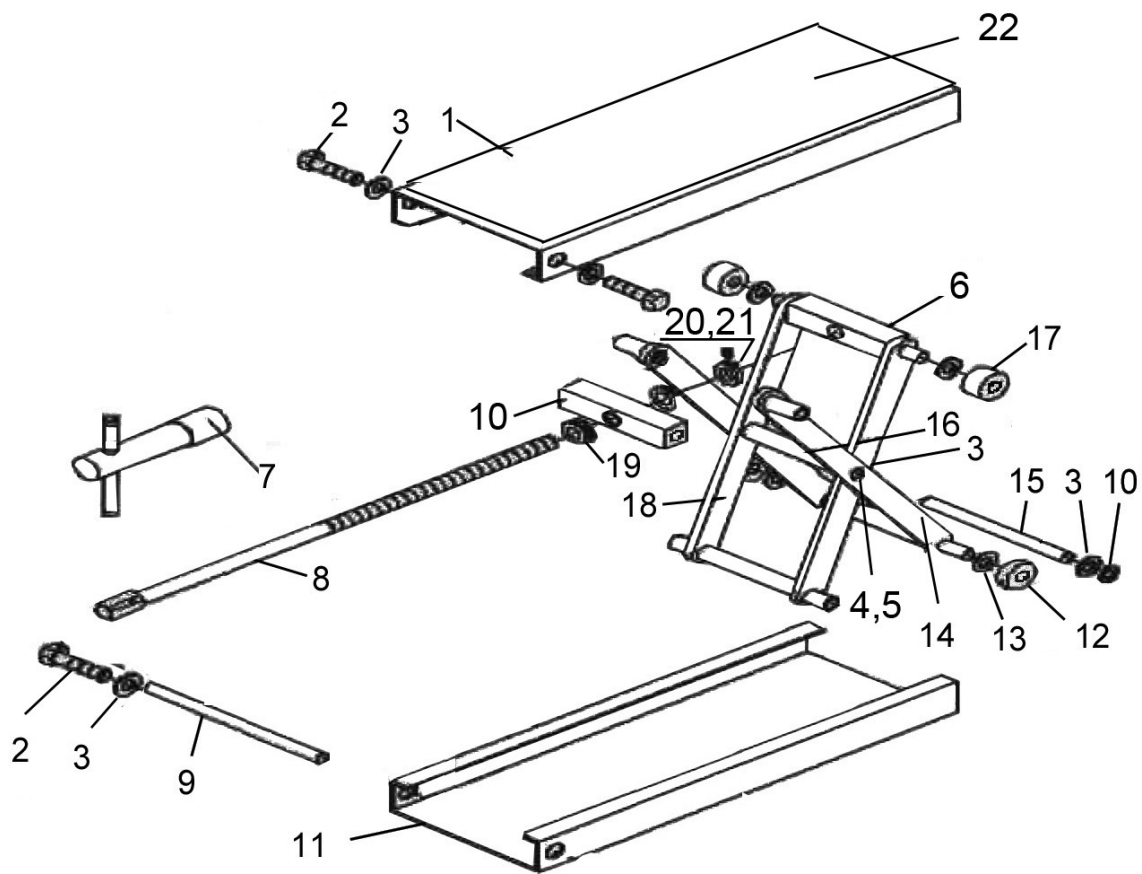

# COMPONENT PARTS





No	Description
1	Table
2	Bolt
3	Washer
4	Washer
5	Socket head screw
6	Rear mounting block
7	Box Wrench
8	Lifting screw
9	Inside fixing spacer
10	Front mounting block
11	Base plate

No	Description
12	Lower frame roller
13	Washer
14	Outer lifting arm
15	Connecting spindle
16	Centre spacer
17	Upper roller
18	Inside lifting arm
19	Bearing
20	Collar
21	Grubscrew
22	Rubber mat

# DECLARATIONS OF CONFORMITY

	 Clarke <sup>®</sup> INTERNATIONAL Fitzwilliam Hall, Fitzwilliam Place, Dublin 2
<b>DECLARATION OF CONFORMITY</b>	
This is an important document and should be retained.	
We hereby declare that this product(s) complies with the following legislation: 2006/42/EC <i>Machinery Directive</i>	
The following standards have been applied to the product(s): EN 1493:2010	
The technical documentation required to demonstrate that the product(s) meet(s) the requirement(s) of the aforementioned legislation has been compiled and is available for inspection by the relevant enforcement authorities.	
The CE mark was first applied in: 2025	
Product Description:	Motorcycle Lift
Model Number(s):	CML9
Serial/Batch Number:	Refer to product/packaging label
Date of issue:	03/07/2025
Signed:	 ..... J.A Clarke Director
CML9 CE Clarke DOC 070325	
Page 1 of 1	

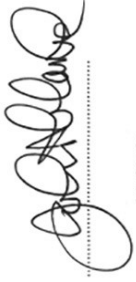
	 Clarke <sup>®</sup> INTERNATIONAL Hemnal Street, Epping, Essex, CM16 4LG
<b>DECLARATION OF CONFORMITY</b>	
This is an important document and should be retained.	
We hereby declare that this product(s) complies with the following legislation: 2006/42/EC <i>Machinery Directive</i>	
The following standards have been applied to the product(s): EN 1493:2010	
The technical documentation required to demonstrate that the product(s) meet(s) the requirement(s) of the aforementioned legislation has been compiled and is available for inspection by the relevant enforcement authorities.	
The UKCA mark was first applied in: 2025	
Product Description:	Motorcycle Lift
Model Number(s):	CML9
Serial/Batch Number:	Refer to product/packaging label
Date of issue:	03/07/2025
Signed:	 ..... J.A Clarke Director
CML9 UKCA Clarke DOC 070325	
Page 1 of 1	

# A SELECTION FROM THE VAST RANGE OF

# Clarke®

## QUALITY PRODUCTS



**AIR COMPRESSORS**  
From DIY to industrial, Plus air tools, spray guns and accessories.

**GENERATORS**  
Prime duty or emergency standby for business, home and leisure.

**POWER WASHERS**  
Hot and cold, electric and engine driven - we have what you need

**WELDERS**  
Mig, Arc, Tig and Spot. From DIY to auto/industrial.

**METALWORKING**  
Drills, grinders and saws for DIY and professional use.

**WOODWORKING**  
Saws, sanders, lathes, mortisers and dust extraction.

**HYDRAULICS**  
Cranes, body repair kits, transmission jacks for all types of workshop use.

**WATER PUMPS**  
Submersible, electric and engine driven for DIY, agriculture and industry.

**POWERTOOLS**  
Angle grinders, cordless drill sets, saws and sanders.

**STARTERS/CHARGERS**  
All sizes for car and commercial use.



## PARTS & SERVICE: 0208 988 7400

**Parts Enquiries**  
[Parts@clarkeinternational.com](mailto:Parts@clarkeinternational.com)

**Servicing & Technical Enquiries**  
[Service@clarkeinternational.com](mailto:Service@clarkeinternational.com)

SALES: UK 01992 565333 or Export 00 44 (0)1992 565335

**Clarke® INTERNATIONAL** Hemnall Street, Epping, Essex CM16 4LG  
[www.clarkeinternational.com](http://www.clarkeinternational.com)